

EMCO Classical Venturi Tube Welded Sheet, Type KVR With Weld end or Flange Connection

Principle

EMCO classical venturi tubes are used as primary elements in flow measurement of steam, liquid and gas according to the differential pressure principle.

Construction

Design standards	: ISO 5167-4, ASME MFC-3M
Sizes	: DN 200 - 1200 according to ISO 5167
Bore/diameter (β)	: $0,4 \leq \beta \leq 0,7$ (ISO 5167), $0,3 \leq \beta \leq 0,75$ (ASME)
Pressure rating	: PN 10 - 100, 150 - 600 lbs, ISO PN 20 - 100
Material	: Carbon steel, AISI 316, others on request
Mounting style	: Weld ends according to DIN 2559 or ANSI B16.25. Flanges acc. to DIN or ANSI B16.5 standards or Clamp connections, like Grayloc
Pressure taps	: Weld ends \varnothing 21.3 mm, 26.9 mm, thread connection 3/8", 1/2" BSP male, 1/2" NPT
Tappings	: Single pressure tappings or 2x4 tappings each arranged with an external annular ring to equalise the pressure
Outlet cone	: 7 - 15°

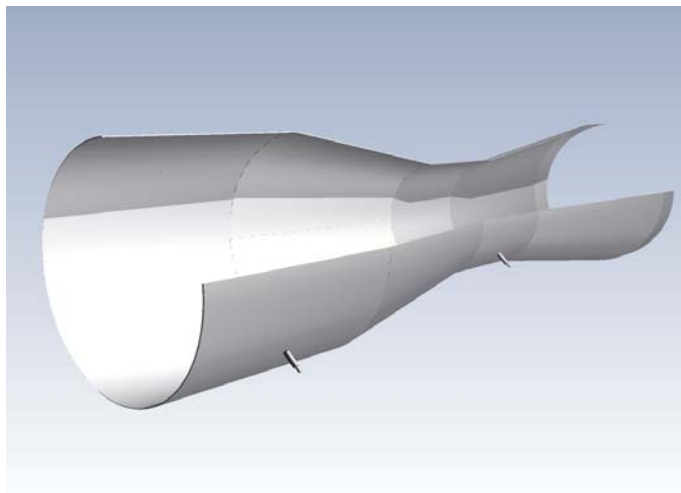

0-06015-3e

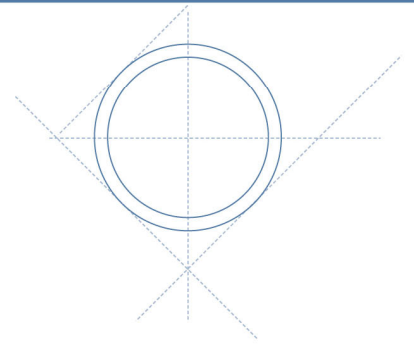

Technical Data

- Accuracy : 1,5 % (according to ISO 5167-4)
- Pressure loss : Depending on outlet cone between 10 - 15 % of the differential pressure measured
- Limits for Re. No. : $2 \times 10^5 < ReD < 2 \times 10^6$ according to ASME
- Accessories : Shut-off valves and condensing chambers for steam flow measurement

